

SD-DRIVE 4



The SD-DRIVE 4 is a four channel dimmer for control of RGBW LED light sources. The small compact size is ideal for installation in confined spaces, and the choice of control modes makes the SD-DRIVE 4 suitable for a wide range of installation applications.

Removable terminal sockets allow for easy replacement, and the twelve position dipswitch enables simple, fast configuration.

Choose from DMX control, or manual or auto control via the onboard dipswitch settings.

Features:

- Output current selectable between 350mA and 750 mA
- Four Channel LED Dimmer
- DMX 512 input
- DMX Start Address configurable
- DMX Control mode , Manual Dim or Auto mode
- 12 position dipswitch for addressing and setup
- Terminal connectors for input and output connections
- Requires power supply

Drawing Diagram:

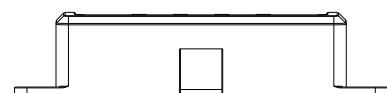
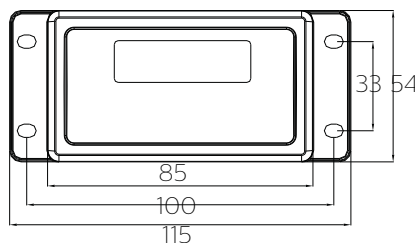
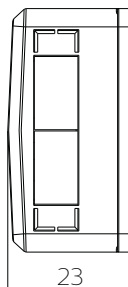

Technical Specifications:

Version:

SD - DRIVE 4 HM ,
IP20

Input:

4 pin Terminal Socket for DC Power 6A Max.
3 pin Terminal Socket for DMX 512 (DMX in)

Output:

8 pin Terminal Socket for DC Power 6A Max.
3 pin Terminal Socket for DMX 512 (DMX out)

Controls:

DMX-512

Physical:

12-24VDC, 6A Max.
115 mm x 54mm x 23mm
100 grams
CE

Modes:

DMX Control Mode
Manual Control Mode
Auto Mode

Ordering

Information:

SD DRIVE 4 , IP20

88-095-2040-00

SDRIVE4

Philips Group 2014. All rights reserved.

The Company reserves the right to make any variation in design or construction to the equipment described. E&OE. Philips Entertainment delivers fully integrated lighting solutions; from simple lamps to complete systems designed with the specific needs of the entertainment and specialized display lighting markets.

www.vari-lite.com