

VARI*LTE

HOUSE OF WORSHIP SMALL SANCTUARY

Application Guide



Small House of Worship

- 
- Multiuse spaces
 - 100 - 300 Seats
 - Smaller seating area and shallow stage
 - Stage, house, and architectural lighting
 - Speaker and music during the service
 - Volunteer operators

Challenge

Solution

Because there are multiple portions of a service, a small sanctuary must address a variety of lighting needs. Stage, architectural, and house lighting is combined in a single space, and lighting can shift from live event lighting during the music to a more theatrical style for the rest of the service.



Churches can leverage cost-effective lighting from Vari-Lite with feature sets targeted at small sanctuaries. With powerful, economical luminaires for both event and theatrical lighting and a console designed to do both well, a Vari-Lite lighting system delivers the perfect solution.

In these smaller worship spaces, the fixtures are installed closer to the stage and the congregation, meaning the fixtures must be compact, with excellent output and wide enough throw angles to cover the entire stage despite shorter distances.

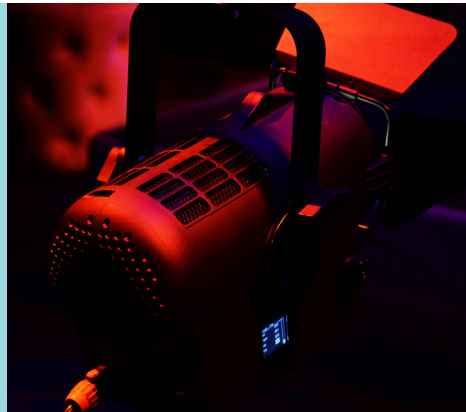

The Acclaim LED Zoomspot can be adjusted from a narrow 25° to a wider 50°, providing the coverage you need, while the VL800 EventWash offers a compact moving wash with an automated zoom for stage wash or back lighting.

Smaller sanctuaries often have lower roofs. This brings fixtures closer to the congregation. Because the fixtures are both visible and potentially audible to the parishioners, it's important that they don't distract from the message.

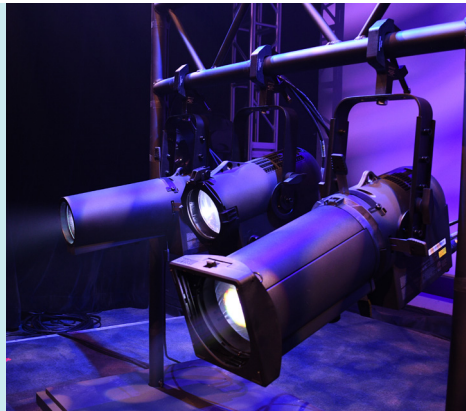

To ensure our fixtures don't become the focus of the service, we include an adjustable fan control, with multiple noise modes. And to ensure the fixtures blend in with any architectural application, Vari-Lite luminaires are available in both black and white body styles.

Because lighting systems are typically controlled by volunteer users in small sanctuaries, architectural lighting and show control must be capable and easy to use.



The intuitive FLX S48 Console ensures anyone from a volunteer to the worship pastor can control the lighting with minimal training. And with the Vision.Net architectural control solution, users can control house and stage lighting effortlessly at the push of a button.

LUMINAIRES

- **Acclaim LED 25° - 50° Zoomspot (x 12)** - full color profile with integrated manual zoom and focus.
- **Acclaim LED Fresnel (x8)** - true full color theatrical Fresnel wash.
- **VL800 EventWash (x 8)** - mid-sized full color LED wash with 7 individually controllable LEDs.
- **Acclaim LED Cyc (x12)** - full color cyclorama fixture designed for small to medium-sized spaces.

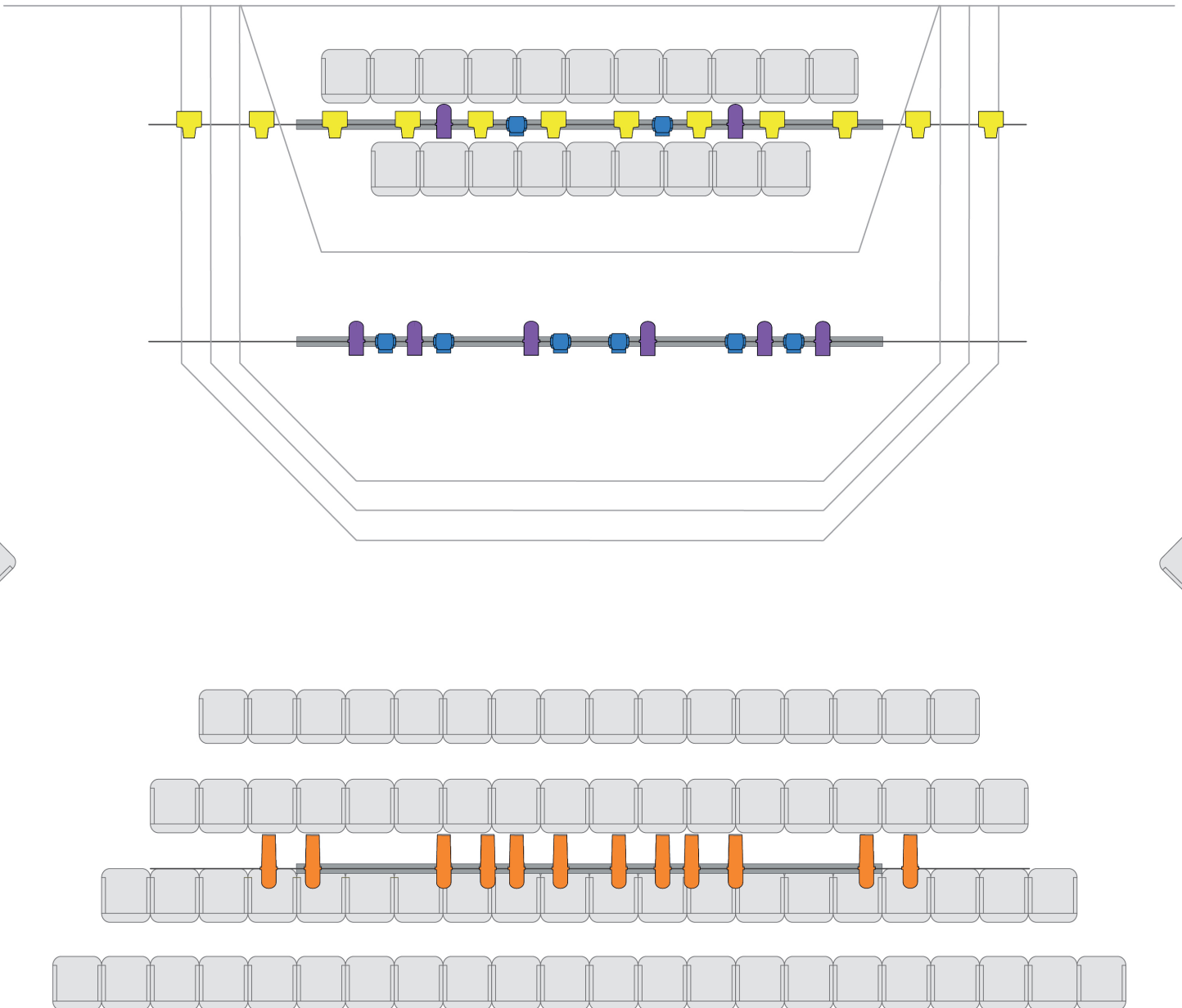

CONNECTIVITY (120V)

FLX S48 Console (x 1) - intuitive lighting console to create beautiful looks in less time.

Vision.Net 10.1" Touchscreen (x 1) - touch-based panel to control a lighting system.

Vision.Net Control Station (x 3) - simple interface for controlling lights during simple events.

Vision.Net Gateway with DMX Module (x 1) - DIN-rail mounted gateway with 4 DMX ports for house and stage light control.

Contact 24 Relay Panel (x 1) - modular panel providing relay-controlled 120V power to fixtures.

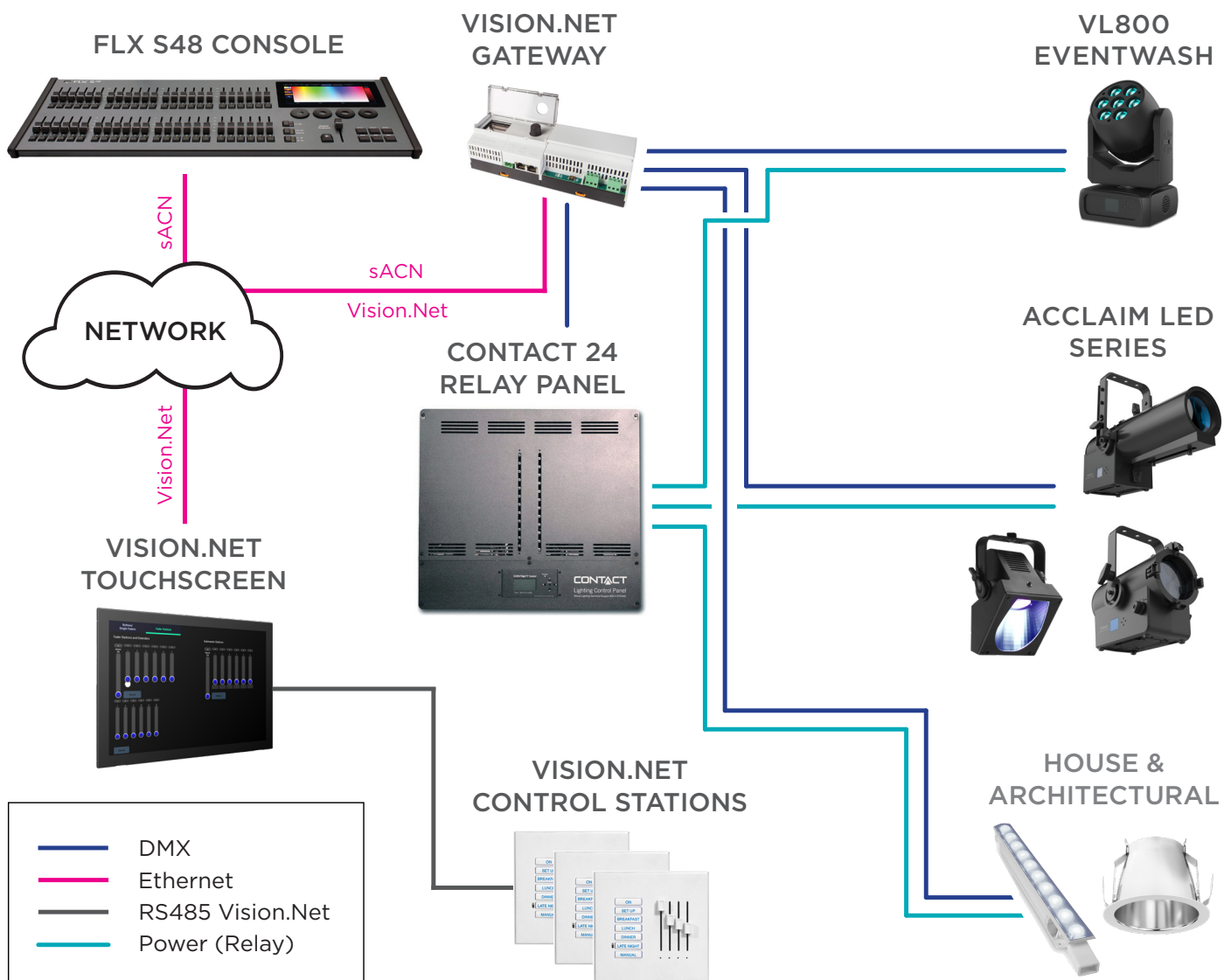

CONNECTIVITY (230V)

FLX S48 Console (x 1) - intuitive lighting console to create beautiful looks in less time.

Vision.Net 10.1" Touchscreen (x 1) - touch-based panel to control a lighting system.

Vision.Net Control Station (x 3) - simple interface for controlling lights during simple events.

Vision.Net Gateway with DMX Module (x 1) - DIN-rail mounted gateway with 4 DMX ports for house and stage light control.

RigSwitch 24 Relay Panel (x 1) - modular panel providing relay-controlled 230V power to fixtures.

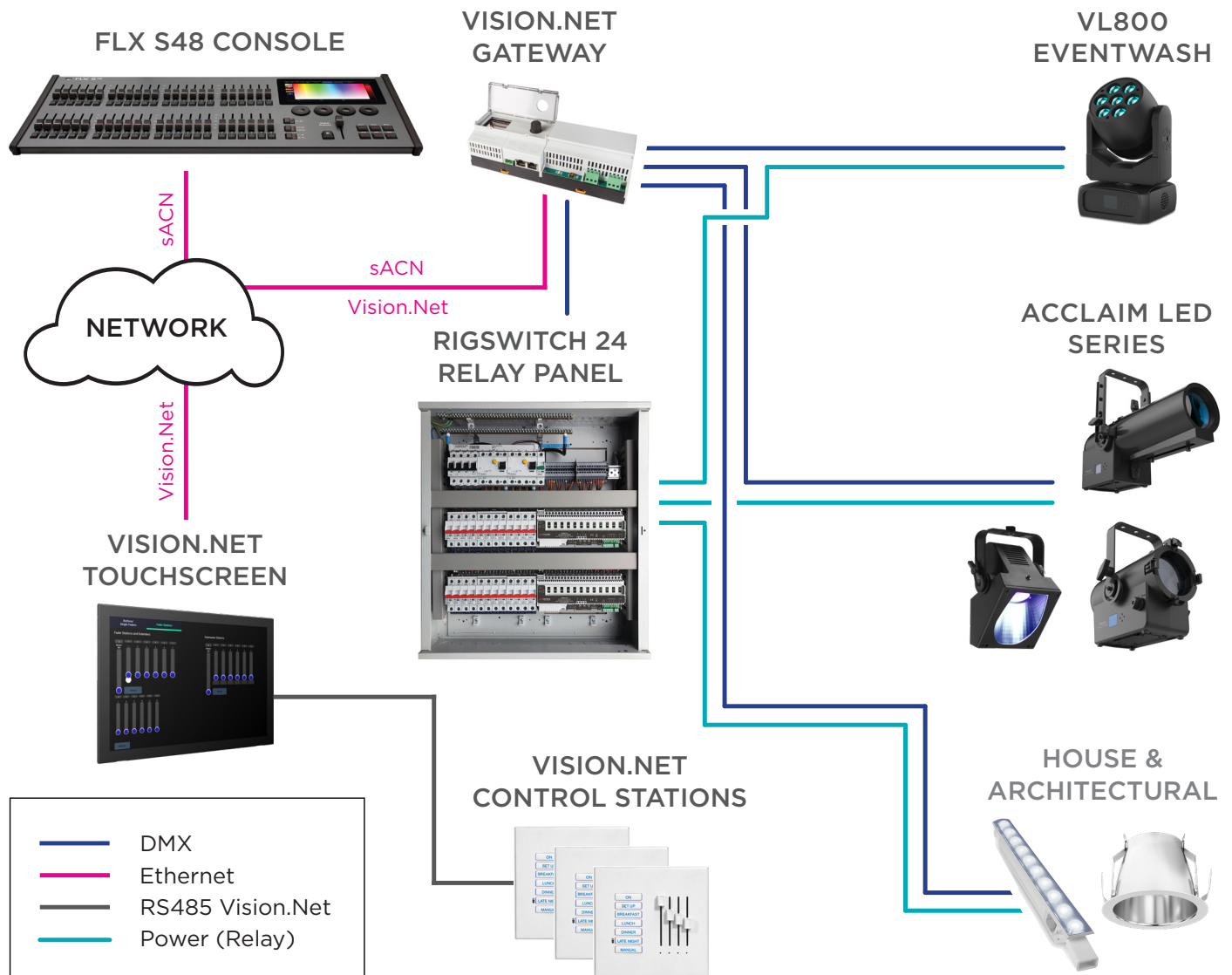



VARI*LTE

©2023 Signify Holding. All rights reserved. All trademarks are owned by Signify Holding or their respective owners. The information provided herein is subject to change, without notice. Signify does not give any representation or warranty as to the accuracy or completeness of the information included herein and shall not be liable for any action in reliance thereon. The information presented in this document is not intended as any commercial offer and does not form part of any quotation or contract, unless otherwise agreed by Signify. Data subject to change.

July 4, 2023

Front cover photos by Daniel Schaffer (top left), Gabriel Gurrola (bottom right), and page 2 photo by Nathan Mullet. On Unsplash.

VARI-LITE

www.vari-lite.com