

VARI*LITE

SMALL AND STUDIO THEATRE

Application Guide



Small and Studio Theatre



- Often occupy found or converted spaces
- 100 - 300 Seats
- Studio, community, fringe, or black box
- Small proscenium or theatre-in-the-round
- Limited gear and budget
- Professionals or volunteer operators

Challenge

Small theatres are often spaces that have been adapted to meet the needs of a theatre. Sometimes these spaces are constructed in the style of a black box, while others have a faux proscenium.



Solution

An integrated Vari-Lite lighting system can provide a complete end-to-end solution to illuminate the variety of events that occur in a small or studio theatre.

The lighting positions are typically fixed and available power and control distribution limited. They are designed in a cost-effective manner to maximize space and performance style flexibility using technology that is value orientated.

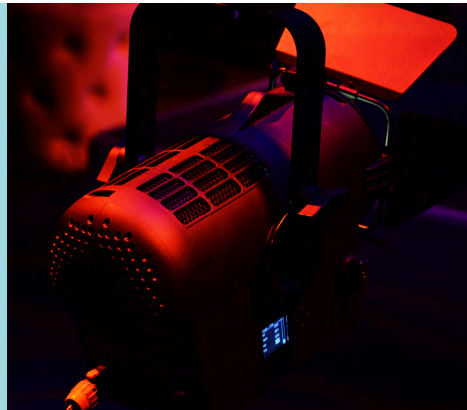

Acclaim LED Series and VL800 Series fixtures provide the flexibility and feature set needed to illuminate any type of performance, with exceptional output and consistent colors.

Because community theatres often have strict time constraints and use packaged pricing, lighting designers must be highly creative with how they use the limited gear already on hand.



To control the space, the FLX S Series offers designer-friendly features in an interface perfect for the novice user.

Small theatre spaces can be used for a variety of different events. Beyond the productions performed in these spaces, small theatres are often rented out to various events run by operators of little to no experience. As such, lighting should be multifunctional and controls should be fast and easy.

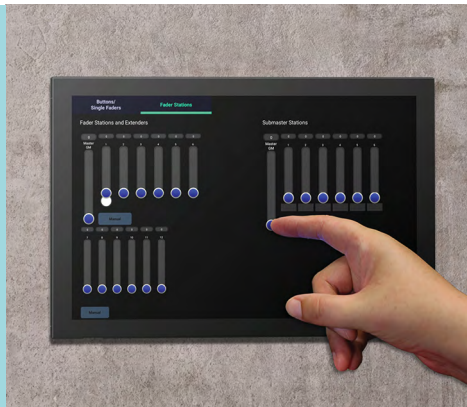

For everyday events, the Vision.Net Touchscreen is as comfortable as your personal tablet. Room lighting can be simply turned on and off, stage lighting looks can be recalled, and basic adjustments made effortlessly with the push of your finger.

LUMINAIRES

- **VL800 EventProfile (x 2)** - compact LED event profile with professional-grade features.
- **Acclaim LED 25° - 50° Zoomspot (x 28)** - full color profile with integrated manual zoom and focus.
- **Acclaim LED Fresnel (x6)** - true full color theatrical Fresnel wash.
- **Acclaim LED Cyc (x6)** - full color cyclorama fixture designed for small to medium-sized spaces.

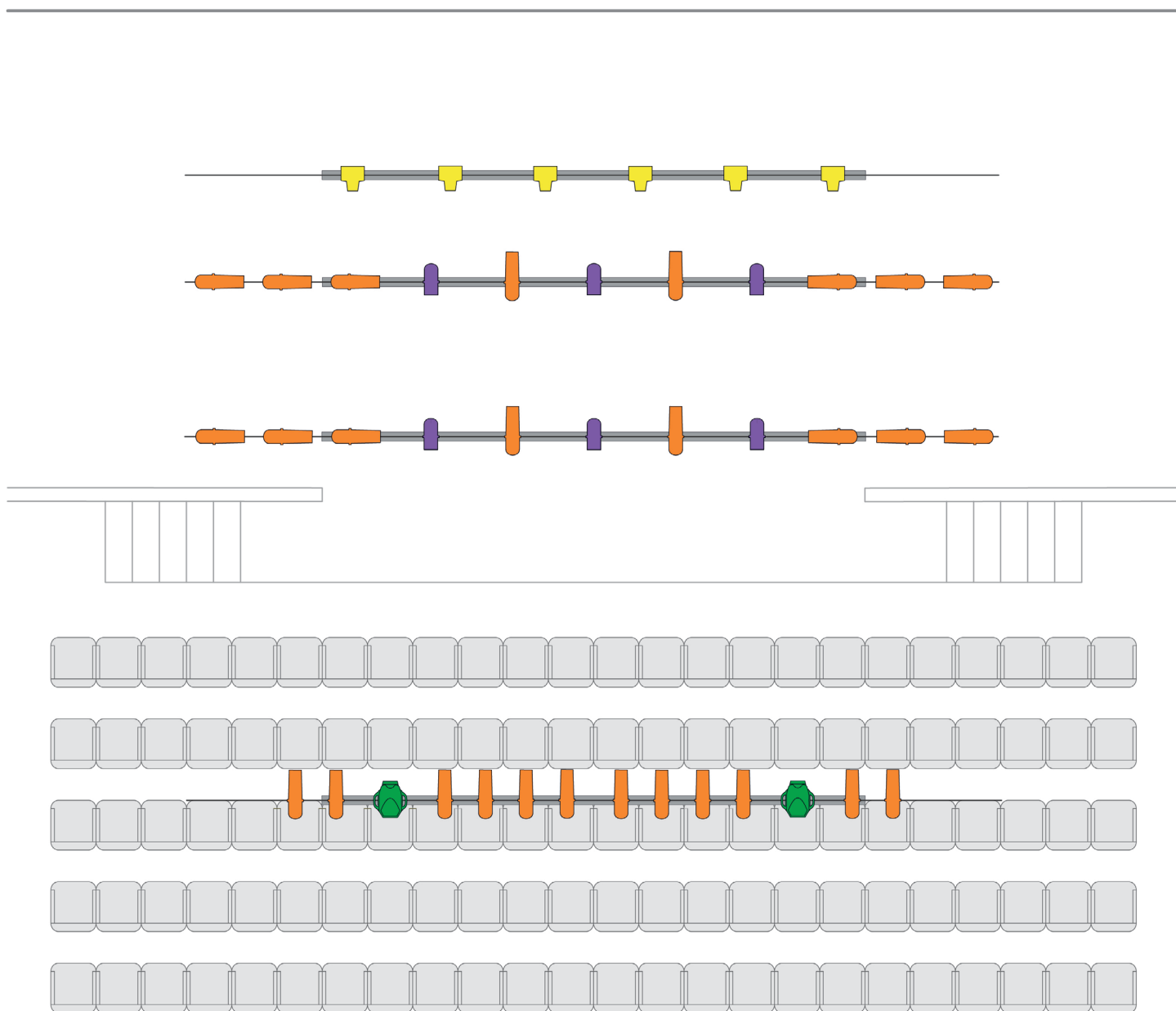

CONNECTIVITY (120V)

FLX S24 Console (x 1) - intuitive lighting console to create beautiful looks in less time.

Vision.Net 10.1" Touchscreen (x 1) - touch-based panel to control a lighting system.

Vision.Net Control Station (x 3) - simple interface for controlling lights during simple events.

Vision.Net Gateway with DMX Module (x 1) - DIN-rail mounted gateway with 4 DMX ports for house and stage light control.

Contact 24 Relay Panel (x 1) - modular panel providing relay-controlled 120V power to fixtures.

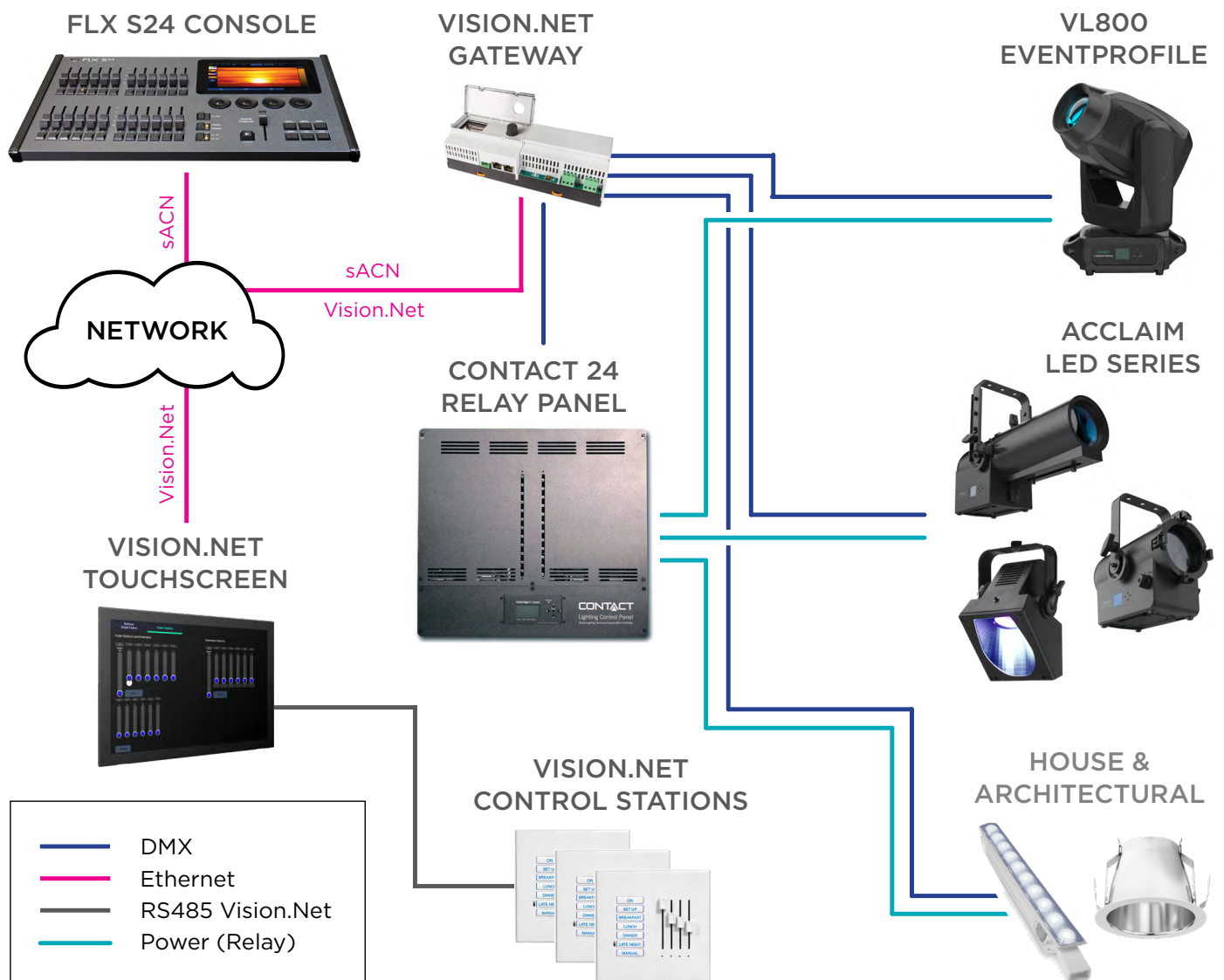

CONNECTIVITY (230V)

FLX S24 Console (x 1) - intuitive lighting console to create beautiful looks in less time.

Vision.Net 10.1" Touchscreen (x 1) - touch-based panel to control a lighting system.

Vision.Net Control Station (x 3) - simple interface for controlling lights during simple events.

Vision.Net Gateway with DMX Module (x 1) - DIN-rail mounted gateway with 4 DMX ports for house and stage light control.

RigSwitch 24 Relay Panel (x 1) - modular panel providing relay-controlled 230V power to fixtures.

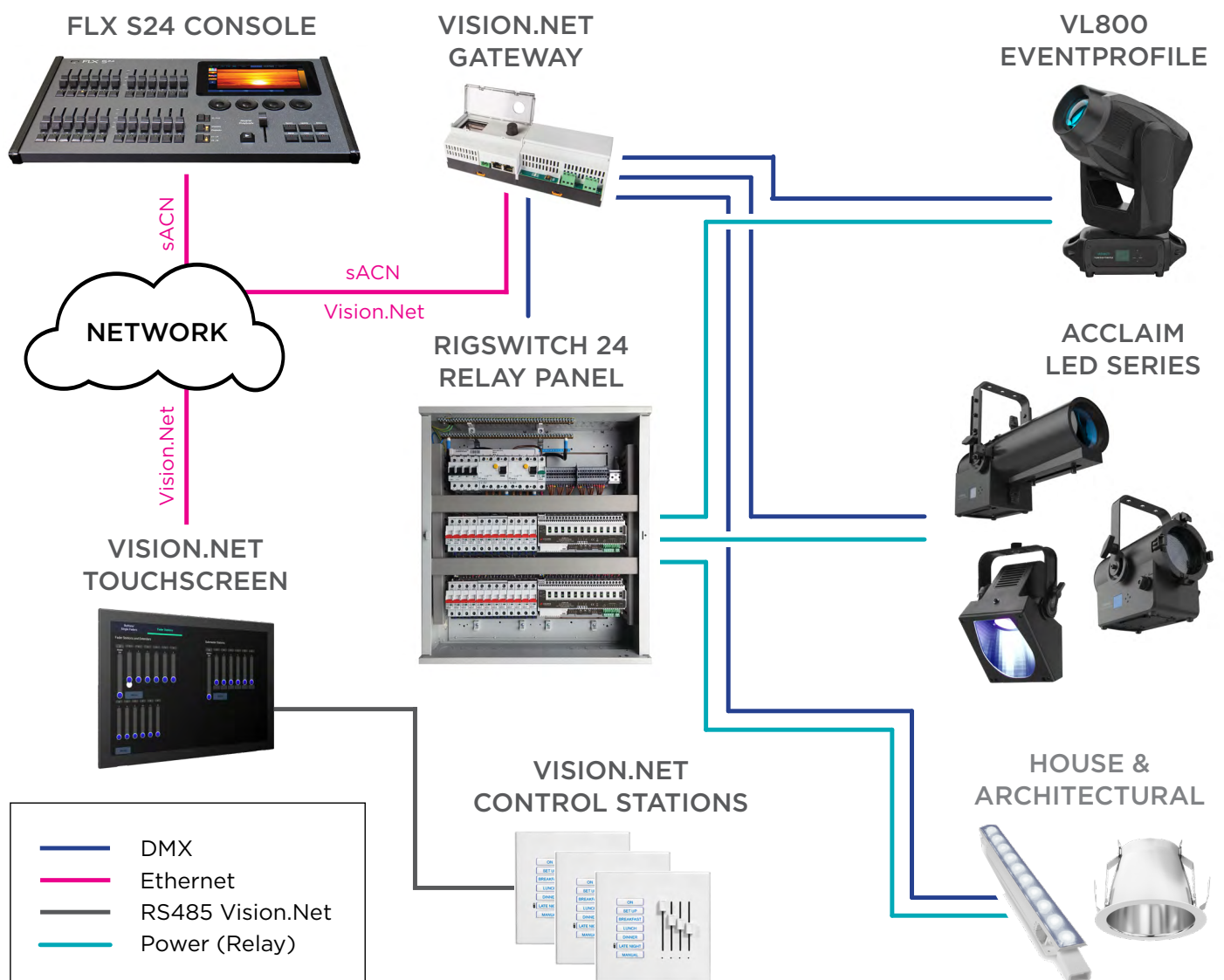



VARI*LITE

©2023 Signify Holding. All rights reserved. All trademarks are owned by Signify Holding or their respective owners. The information provided herein is subject to change, without notice. Signify does not give any representation or warranty as to the accuracy or completeness of the information included herein and shall not be liable for any action in reliance thereon. The information presented in this document is not intended as any commercial offer and does not form part of any quotation or contract, unless otherwise agreed by Signify. Data subject to change.

VARI-LITE

www.vari-lite.com

April 26, 2023